

1

2

3

4

A

B

C

D

E

Possible type of female part "FU"

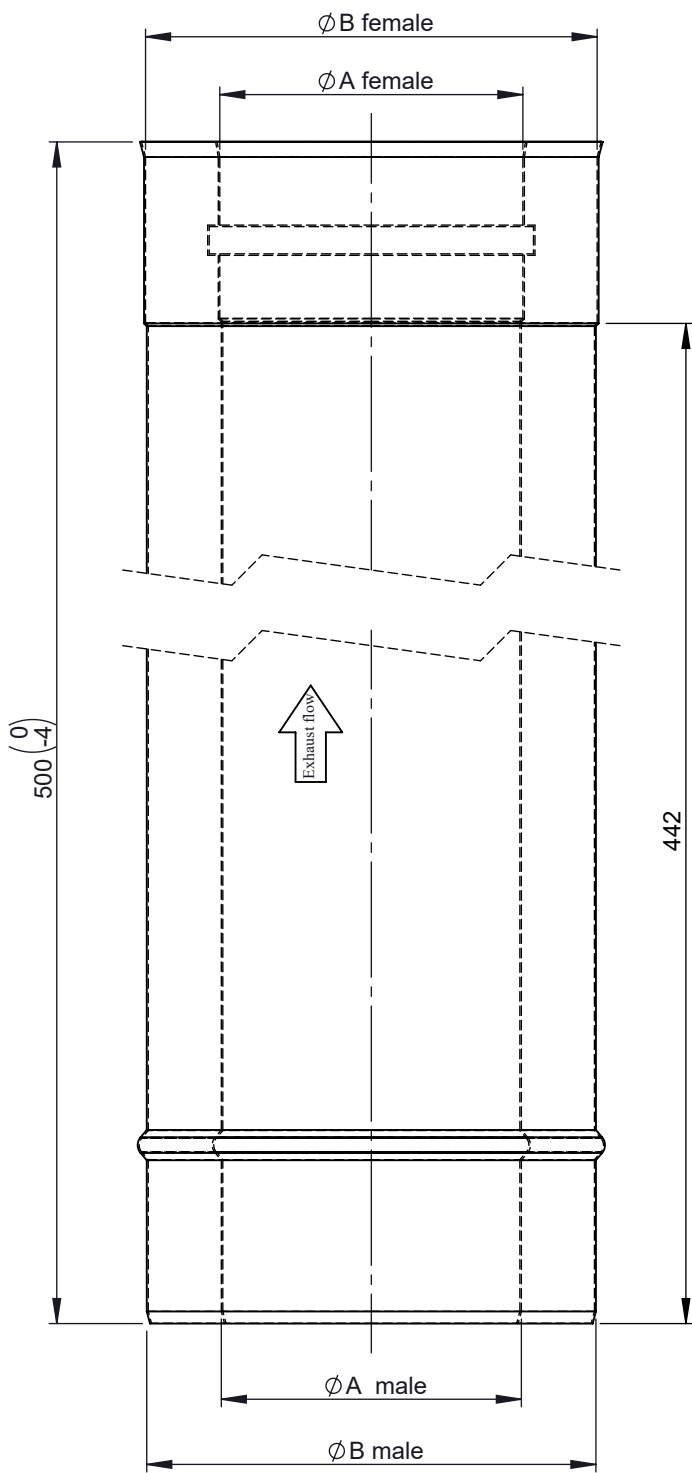
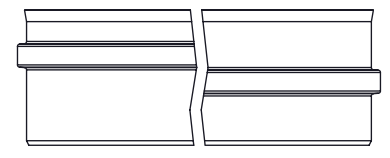

1:5 (100/150)

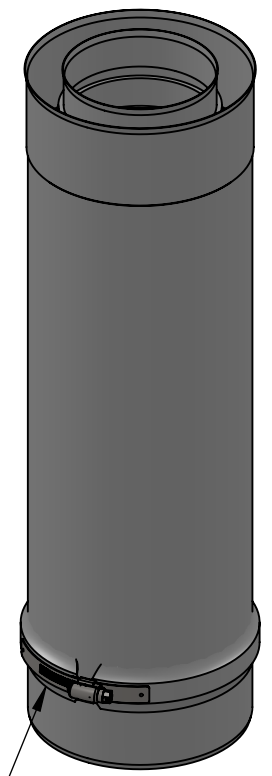

incl. system clamp

Ø	100/150	130/200	150/200
A	100	130	150
B	150	200	200
kg	1.7	2.2	2.3

notes:
ENCD

DIN ISO 13920 Tolerances B

revisions-no. A mm / kg

	date	name
drawn by	20.12.19	MWI
checked by	20.12.19	SWA
approved by	20.12.19	JWY
modified by		

Jeremias[®]
CHIMNEY SYSTEMS

description: Straight pipe element 500mm

code: H-TWIN 14 Ø

drawing-no.: 01-03-03-4300-000

scale: 1:10

format: A4

sheet: 1 of 1



© Jeremias GmbH. All rights reserved, also regarding any disposal, exploitation, editing, distribution, as well as in the event of applications for industrial property rights.